

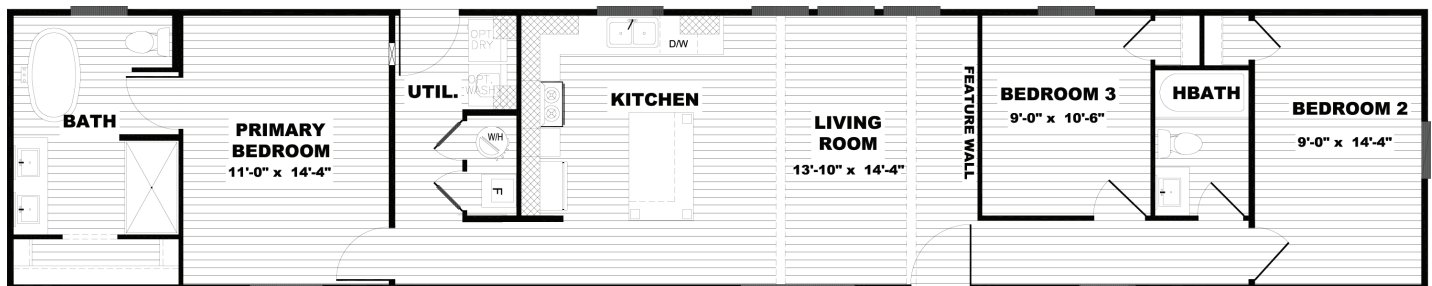

# Lexi

52NXT16763DH / 3 beds / 2 baths / 1,140 sq. ft. / 16x76



## Standard Features

- White, Clay or Flint vinyl siding with OSB sheathing
- 30 Year Architectural shingles
- Dual porch lights at front door
- Artisan front door (Blue or White)
- Optional artisan 6 pane glass front door (blue or white)
- Full-view storm door
- Ring® HD video doorbell
- Kwikset® black interior and exterior door hardware
- Tape and textured walls throughout
- 3" iron mountain pine trim around doors, windows, at the ceiling, and baseboards in linoleum areas
- Shaw Resilient® linoleum standard in all living rooms, primary bedrooms, and wet areas
- Custom wood shelving in closets with rod
- White or Black Shiplap feature wall
- Carpet standard in primary bedroom with Shaw Resilient® linoleum in all other areas
- Iron mountain pine ceiling beams
- 200 amp service
- Black ceiling fan with light in primary bedroom and living room or den
- USB recept in islands
- Large single-level island
- Iron mountain pine ceiling beams
- DuraCraft® cabinets in four colors (any of the four colors can be used on the island) with shaker profile. PVC scratch-resistant and water-repellant
- Drawer over base door construction
- 43" overhead cabinets
- Samsung® appliances in stainless steel
  - Package includes 27" side-by-side with water/ice, smooth top range, dishwasher, and stainless steel microwave over range
- Pfister® brushed nickel gooseneck faucet with sprayer in stainless steel farmhouse apron sink
- All homes are constructed with eBuilt® features
- R-22/R-13/R-38 insulation values
- Overhead air ducts
- Lux Low-E windows – 60", 4 over 1 gridded with bronze finish
- ecobee® Smart Thermostat
- Rheem® dual-element 40-gallon water heater
- SmartComfort® Carrier® furnace – electric up-flow air
- LED can lights throughout
- 60" fiberglass shower with black pivot door in primary bath
- Square porcelain sinks
- Pfister® black faucets in both baths
- Iron mountain pine or white trimmed mirrors
- 60" fiberglass tub/shower combo in hall bath
- Freestanding Designer Tub
- White tile backsplash in kitchen and baths
- Floating shelves above toilet in primary bathroom
- Shirt/Skirt shelving in primary bedroom closet

## Available Upgrades

- |   |   |   |
|---|---|---|
| <input type="checkbox"/> Wind Zone 2                          | <input type="checkbox"/> Add 2 Extra Gallons Interior Paint to Ship Loose                   | <input type="checkbox"/> eBuilt® Plus with 40-Gallon heat pump water heater |
| <input type="checkbox"/> 30 # Roof Load                       | <input type="checkbox"/> 2" Blinds Throughout   | <input type="checkbox"/> Smart Home Upgrade Package                         |
| <input type="checkbox"/> 40 # Roof Load (Colorado Only)       | <input type="checkbox"/> Gas Furnace w/ Floor Registers                                     | <input type="checkbox"/> Add Artisan Front Door to Front Sidewall           |
| <input type="checkbox"/> Gas Range                            | <input type="checkbox"/> 100 AMP Service  | <input type="checkbox"/> Optional SmartPanel Exterior Siding                |
| <input type="checkbox"/> Castico Marble Shower with Barn Door | <input type="checkbox"/> AC Disconnect  | <input type="checkbox"/> White Trim   |
| <input type="checkbox"/> Lino Throughout                      | <input type="checkbox"/> Black Metal Roof   | <input type="checkbox"/> Optional SGD IPO 3 windows                         |
| <input type="checkbox"/> Add Lino to Bedroom                  | <input type="checkbox"/> Optional shiplap feature wall in white or black in primary bedroom |   |
| <input type="checkbox"/> Add 5 Gallons Exterior Paint         | <input type="checkbox"/> Optional electric fireplace  |   |

Customer Name \_\_\_\_\_ Customer Signature \_\_\_\_\_

CSM \_\_\_\_\_ Phone Number \_\_\_\_\_ County \_\_\_\_\_

\*All Options Subject to Change Without Notice

[View your color options and more with our virtual Home Builder at claytonnxt.com](https://www.claytonnxt.com)