

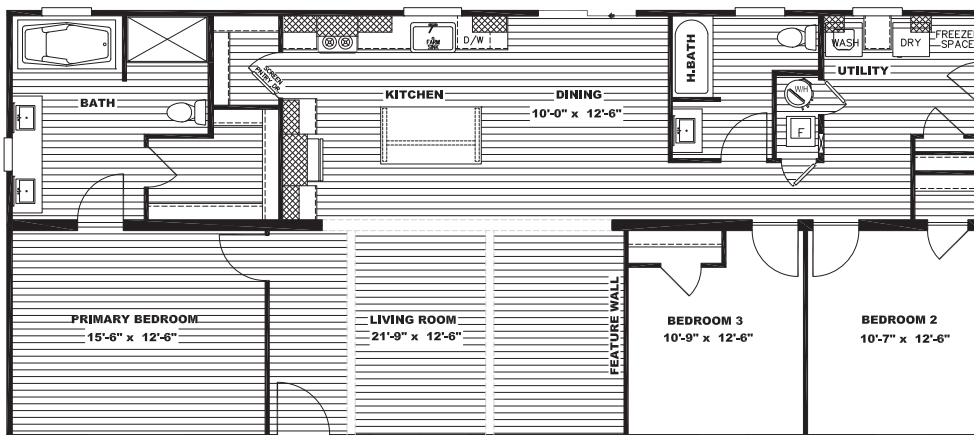

EXCLUSIVE TO CLAYTON HOMES RETAILERS

Farm 3 Flex

52FRM28603AH / 3 beds / 2 baths / 1,580 sq. ft. / 28x60

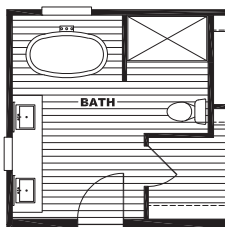

Standard Features

- White, Clay or Flint vinyl siding with OSB sheathing
- 30 Year Architectural shingles
- 20' dormer with SmartPanel insert and columns
- Dual porch lights at front door
- Artisan front door (Blue or White)
- Optional artisan 6 pane glass front door (blue or white)
- Full-view storm door
- Ring® HD video doorbell
- Kwikset® black interior and exterior door hardware
- Sliding glass patio door
- Tape and textured walls throughout
- 3" iron mountain pine trim around doors, windows, at the ceiling, and baseboards in linoleum areas
- Shaw Resilient® linoleum standard in all living rooms, primary bedrooms, and wet areas
- Custom wood shelving in closets with rod
- White or Black Shiplap feature wall
- Shaw Resilient® R2X® 25 oz residential carpet is standard in spare bedrooms with built-in stain treatment
- Iron mountain pine ceiling beams
- 200 amp service
- Black ceiling fan with light in primary bedroom and living room or den
- USB receipt in islands
- Large single-level island
- Drop-in tub w/ 36x48 window
- DuraCraft® cabinets in four colors (any of the four colors can be used on the island) with shaker profile. PVC scratch-resistant and water-repellant
- Drawer over base door construction
- 43" overhead cabinets
- Samsung® appliances in stainless steel
 - Package includes 27" side-by-side with water/ice, smooth top range, dishwasher, and stainless steel microwave over range
- Pfister® brushed nickel gooseneck faucet with sprayer in stainless steel farmhouse apron sink
- Two black pendant lights over the island
- All homes are constructed with eBuilt® features
- R-22/R-13/R-38 insulation values
- Overhead air ducts
- Lux Low-E windows – 60", 4 over 1 gridded with bronze finish
- ecobee® Smart Thermostat
- Rheem® dual-element 40-gallon water heater
- SmartComfort® Carrier® furnace – electric up-flow air
- LED can lights throughout
- Drop-in tub with 36x48 window
- 60" fiberglass shower with black pivot door in primary bath
- Square porcelain sinks
- Pfister® black faucets in both baths
- Iron mountain pine or white trimmed mirrors
- 60" fiberglass tub/shower combo in hall bath
- Screen pantry door
- White tile backsplash in kitchen and baths
- Floating shelves above toilet in primary bathroom
- Awning over living room window
- Shirt/Skirt shelving in primary bedroom closet
- White or Black Island Shiplap

Available Upgrades

- | | | |
|--|---|---|
| <input type="checkbox"/> Wind Zone 2 | <input type="checkbox"/> Add 2 Extra Gallons Interior Paint to Ship Loose | <input type="checkbox"/> Optional 36x60 Mulled Windows ipo Sliding Glass Door in Dining |
| <input type="checkbox"/> 2x6 Exterior Walls | <input type="checkbox"/> 2" Blinds Throughout | <input type="checkbox"/> Ceiling fans in spare bedrooms |
| <input type="checkbox"/> 30 # Roof Load | <input type="checkbox"/> Gas Furnace w/ Floor Registers | <input type="checkbox"/> Quartz island |
| <input type="checkbox"/> 40 # Roof Load (Colorado Only) | <input type="checkbox"/> 100 AMP Service | <input type="checkbox"/> White trim |
| <input type="checkbox"/> Gas Range | <input type="checkbox"/> AC Disconnect | <input type="checkbox"/> Black Metal Roof |
| <input type="checkbox"/> Castico Marble Shower with Barn Door | <input type="checkbox"/> Optional Coat Locker IPO Freezer Space | <input type="checkbox"/> Optional shiplap feature wall in white or black in primary bedroom |
| <input type="checkbox"/> Lino Throughout | <input type="checkbox"/> Smart Home Upgrade Package | <input type="checkbox"/> Optional electric fireplace |
| <input type="checkbox"/> Add Carpet in Primary Bedroom (Multi-Sections Only) | <input type="checkbox"/> Black Matte Wood Burning Fireplace | <input type="checkbox"/> eBuilt® Plus with 40-Gallon heat pump water heater |
| <input type="checkbox"/> Add Lino to Bedroom | <input type="checkbox"/> Optional Freestanding Designer Tub | |
| <input type="checkbox"/> Add 5 Gallons Exterior Paint | <input type="checkbox"/> Optional SmartPanel Exterior Siding | |

Customer Name _____ Customer Signature _____

CSM _____ Phone Number _____ County _____

*All Options Subject to Change Without Notice

[View your color options and more with our virtual Home Builder at claytonnxt.com](http://claytonnxt.com)